

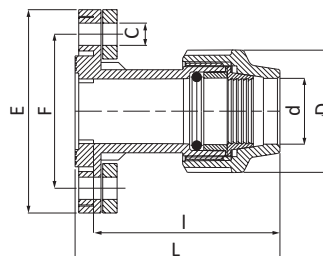

CODE 1011

Raccordo con flangia - Flanged adaptor - Raccord à bride - Enlace brida - Flansch-Muffenstück mit Klemmverschraubung
 Фланец присоединительный



CODE	DIM dxDN [mmxin]	D [mm]	L [mm]	I [mm]	E [mm]	F [mm]	C [mm]	NF [mm]	PN [bar]	PACK RIF. 2	PACK RIF. 5
1011040006001	40x1"1/2 (DN40)	80	141	128	152	110	18	4	16	-	20

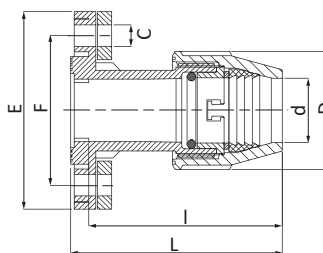

>>>

1011051006001	50x1"1/2 (DN40)	96	162	148	152	110	18	4	16	-	14
1011051007001	50x2" (DN50)	96	162	148	165	125	18	4	16	-	14
1011064007001	63x2" (DN50)	115	193	178	165	125	18	4	16	-	13
1011064008001	63x2"1/2 (DN65)	115	193	178	184	144	18	4	16	-	13
1011076008001	75x2"1/2 (DN65)	129	201	186	184	144	18	4	16	-	8
1011076009001	75x3" (DN80)	129	203	186	198	158	18	8	16	-	7
1011091009001	90x3" (DN80)	155	220	202	198	158	18	8	16	-	6
1011091010001	90x4" (DN100)	155	223	202	220	180	18	8	16	-	6
1011111010001	110x4" (DN100)	183	253	233	220	180	18	8	16	-	4

Flangia di rinforzo in acciaio zincato
 Reinforcement flange made of zinc-plated steel
 Bride de renfort en acier zingué
 Brida de refuerzo de acero galvanizado
 Verstärkungsflansch aus verzinktem Stahl
 Усилительный фланец из оцинкованной стали